

# Main Panels

## Back Panel for BASIC, 380V, CE, 16-0062-9

**NOTE:** For older panels with individual LED lights, refer to Items 56 and 57 in table.

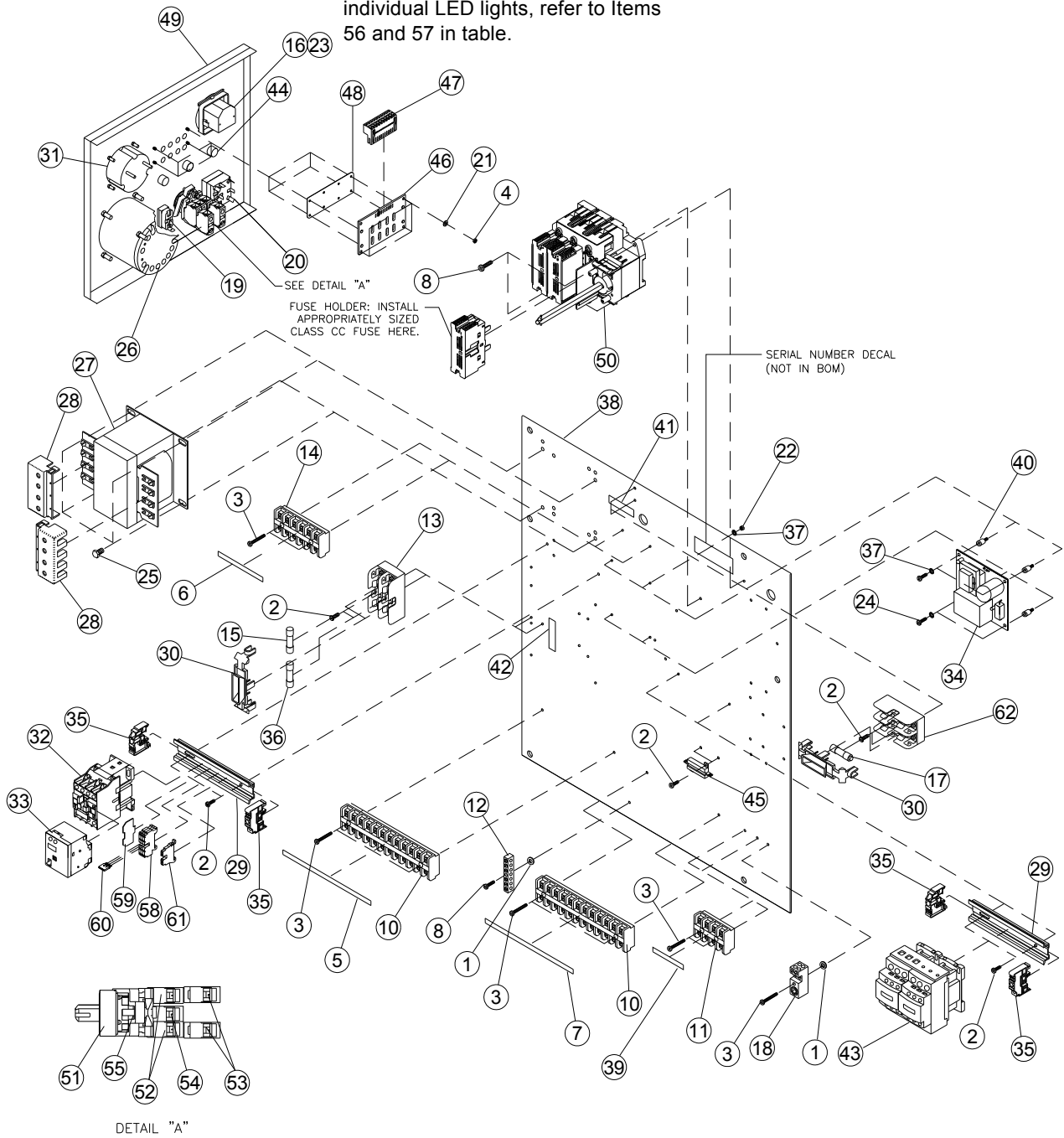



# Main Panels

## Back Panel for BASIC, 380V, CE, 16-0062-9

Ref.	Original Part No.	Substitute Part No.	Description	Ref.	Original Part No.	Substitute Part No.	Description
1	06-0844-8		Washer, Lock, 1/4", I-Tooth	32	11-7391-3		Relay, 2nd, 2NC (Latch)
2	06-0847-1		Screw, #8-32 x 3/8", Ph. Pn Hd,#23	33	11-7392-1		Latch, Relay, 120V
3	06-0850-5		Screw, #8-32 x 1", Ph. Pan Hd, #23	34	11-7465-5		Board, PC, 2 Sec. Delay
4	06-2200-1		Nut, #6-32, Hex	35	11-7467-1		Rail, Din, End
5	06-4347-8		Decal, Term. Marker, T Block 3,10	36	11-7487-9		Fuse, 1.25 AMP, 500V, D.E.T.D.
6	06-4351-0		Decal, Term. Marker, Term Block 2	37	11-7754-2		Washer, Lock, #4, I-Tooth
7	06-4352-8		Decal, Term. Marker, Term Block 1	38	11-7805-2		Panel, Back
8	06-4553-1		Screw, #8-32 x 3/4", Ph. Pn Hd,#23	39	11-7833-4		Decal, Terminal Marker
9	09-0824-4		Base, Wire Tire Support	40	11-7862-3		Spacer, Male/Fem., .25 Hex, 4-40
10	09-7602-7		Block, Term., 12 Pt, CR151B26AF	41	14-8905-0	1600312	Decal, Fuse Size (2) 1.25AMP CC
11	09-7604-3		Block, Term., 4 Pt. CR151BA46AF	42	11-8331-1		Decal, Fuse Size, 1.25-5 AMP
12	09-7631-6		Bar, Ground Terminal, 6-#14, 6-#8	43	11-8921-0		Contact, 3P Rev, w/Aux
13	09-8870-9		Fuseholder, 600V, 30A, 2 Pole	44	11-9860-0		Plug, Hole, Nylon, 7/16"
14	09-9059-8		Block, Term., 6 Pt., #CR151B66AF	45	12-1159-0		Resistor Assy, 2K, 25W
15	09-9064-8		Fuse, 5 AMP, 500V, D.E.T.D.	46	13-4326-0		Board, PC, BASIC, LED
16	09-9132-3		Timer, Hour Meter, Pnl Mt w/o Bez	47	13-4347-0		Connector, Plug, 10 Position, Edge
17	14-8903-0	1600469	Fuse, 1.25Amp,600VAC, Class CC	48	13-4502-0		Gasket, LED Board
18	09-9208-1		Terminal, Lug,2#2/0, 4#4-14,#10	49	16-0050-7		Panel, Insert, BASIC
19	09-9232-1		Switch, Toggle, SPST	50	1602086		Disconnect, (KIT) IEC 1600943
20	09-9286-7		Switch, Toggle, 3 PDT, On-On	51	14-0020-0		Switch, Operator, 3 Pos, Spr. Ret.
21	10-5071-5		Washer, Lock, #6, I-Tooth	52	14-0021-0		Switch, Block, N.O., #101
22	10-9672-6		Nut, #4-40, Hex	53	14-0023-0		Switch,Block,NO,Early Make,#201
23	10-9993-6		Bezel, Hour Meter	54	14-0024-0		Switch,Block, NC,Late Break,#202
24	11-0707-7		Screw, #4-40 x 1/4", Sl. Pan Head	55	14-0026-0		Switch, Operator, Base
25	11-3062-4		Screw, 1/4-20 x 3/8", Hex, Typ.#23	56	11-7481-2		Light, Green, LED, 28 VAC
26	11-4754-5		Timer, Percent, 60 Sec., Solid St	57	11-7482-0		Light, Green, LED, 125 VAC
27	11-5015-0	1600227	Transformer, 380V, .5 KVA, CE	58	12-3868-0		Block, Terminal, Clamp, 4
28	11-5016-8		Cover, Transformer, Term,9070FS	59	12-3873-0		Block, Terminal, Clamp, 4, End
29	11-6044-9		Rail Din, 5.875"	60	12-8118-0		Block, Terminal, Clamp, 3, Jmpr
30	11-7352-5		Cover, Fuse Holder, CE	61	12-3864-0		Block, Terminal, Clamp, 2, Gnd
31	11-7379-8		Meter, 600V, CE	62	12-6800-0		Fuseholder, 600V, 30 Amp, 2 Pole

**NOTE:** For panels with individual LED lights, refer to Items 56 and 57.