

Main Panels

Back Panel, BOSS, 380/400V, 16-0077-7

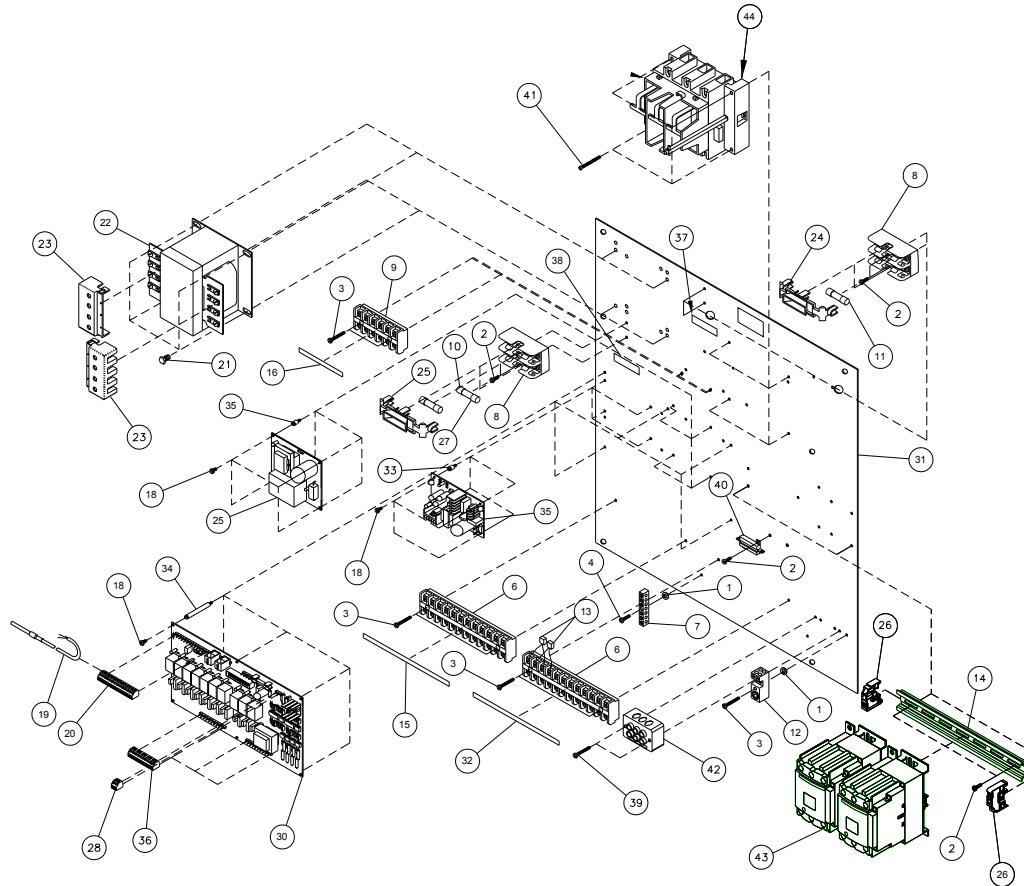

Ref.	Original Part No.	Substitute Part No.	Description
1	06-0844-8		Washer, Lock, 1/4", I-Tooth
2	06-0847-1		Screw, #8-32 x 3/8", Ph. Pn Hd.#23
3	06-0850-5		Screw, #8-32 x 1", Ph. Pan Hd, #23
4	06-4553-1		Screw, #8-32 x 3/4", Ph. Pn Hd,#23
5	09-0824-4		Base, Wire Tire Support
6	09-7602-7		Block Terminal, 12Pt.
7	09-7631-6		Bar, Ground, Terminal, 6-#14, 6-#8
8	09-8870-9		Fuseholder, 600V, 30A, 2 Pole
9	09-9059-8		Block, Terminal, 6 Pt. #CR151B66
10	09-9064-8		Fuse, 5 AMP, 500 Volt, DETD
11	09-9141-4		Fuse, 3.2 AMP, 500 Volt, DETD
12	09-9208-1		Terminal, Lug, 2#2/0, 4#4-14, #10
13	09-9341-0		Suppressor, ARC, 200 VDC,Mod. 2
14	10-8757-6		Rail, Din, 10" AIMS
15	10-9224-6		Decal, Term., Marker, Aux.
16	10-9319-4		Decal, Term. Marker, 12V
17	10-9672-6		Nut, #4-10, Hex
18	11-0707-7		Screw, #4-40 x 1/4", Sl. Pan Head
19	11-0525-3		Sensor, Temperature Monitor
20	11-0954-5		Connector, Plug, 5 MM, 14 Pos.
21	11-3062-4		Screw, 1/4-20 x 3/8", Hex, Typ.#23
22	11-5015-0	1600227	Transformer, 380/400/415 Volts

Ref.	Original Part No.	Substitute Part No.	Description
23	11-5016-8		Cover, Transformer, Term 9070FS
24	11-7352-5		Cover, Fuse Holder, CE
25	11-7465-5		Board, PC, 2 Second Delay
26	11-7467-1		Rail, Din, End Stop
27	11-7487-9		Fuse, 1.25 AMP, 500V, DETD
28	11-7722-9		Connector, Plug, 5 MM 2 Position
29	11-7754-2		Washer, Lock, #4, I-Tooth
30	11-7776-5		Board, PC, Relay, BOSS
31	11-7805-2		Panel, Back
32	11-7832-6		Decal, Term. Marker, BOSS
33	11-7862-3		Spacer, Male/Female, 25 Hex 4-40
34	11-7863-1		Spacer, Male/Female, 2" Hex 4-40
35	11-7897-9		Power Supply, BOSS Assy
36	11-8276-5		Connector, Plug, 5 MM, 10 Position
37	11-8330-2		Decal, Fuse, Size (2)-3.2 AMP
38	11-8331-1		Decal, Fuse, Size, 1.25-5 AMP
39	11-9972-0		Screw, #8-32 x 1-1/4
40	12-1512-0		Resistor Assy, 2K, 25W
41	12-2001-0		Screw, #8-32 x 1-1/2" Ph. Pan Hd.
42	14-2462-0		Block Term., 3 Pt.
43	14-2465-0		Contact, 3P, Rev, 50A, Aux, Sqd
44	1601930		Disconnect, IEC Fused, Mod.