

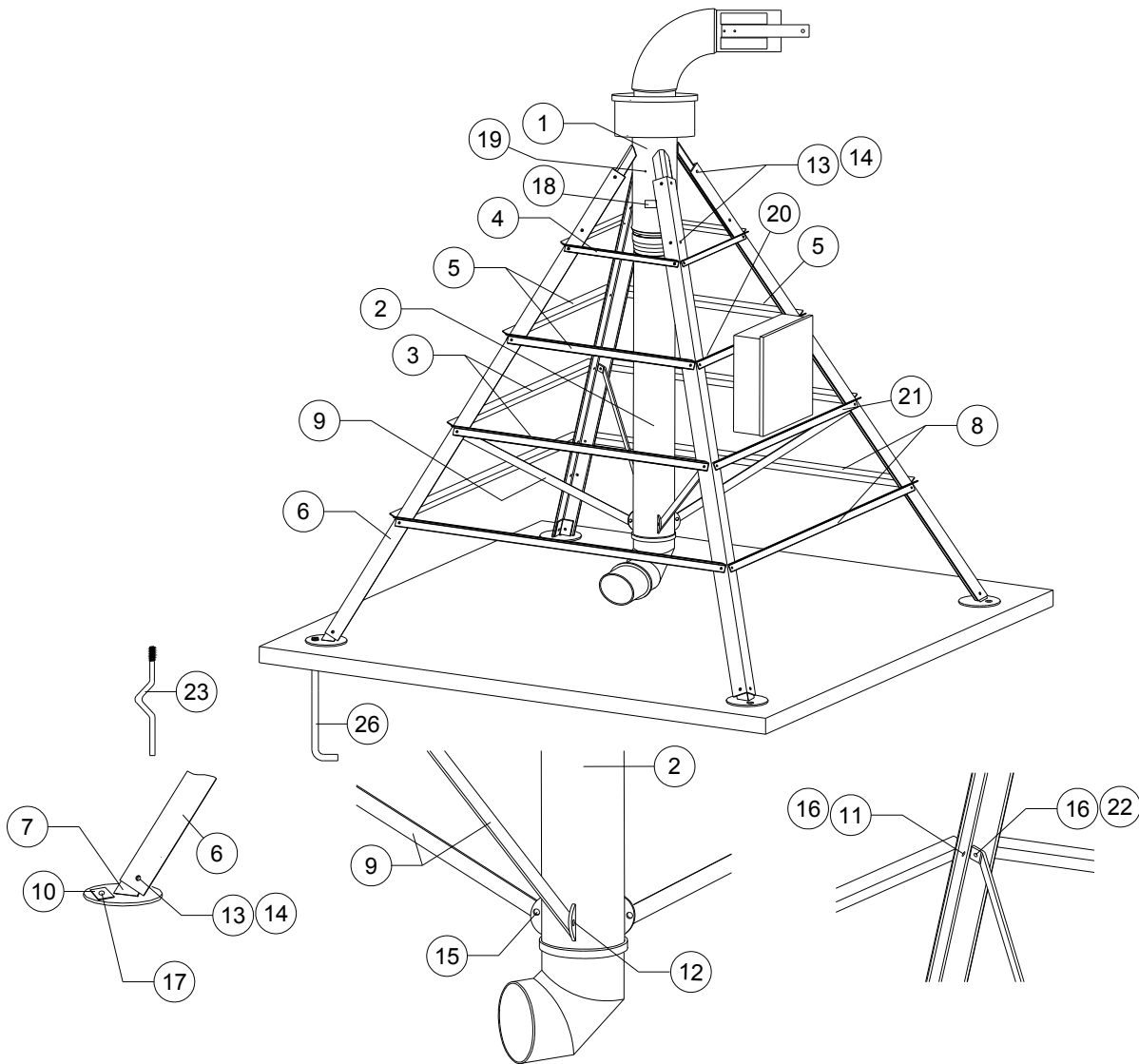

Pivot Points

Heavy Duty Non-Tow, 8-5/8", 8", 6-5/8", 5-9/16"



Ref.	Original Part No.	Substitute Part No.	Description
1	03-0030-1		Head Weldment, Pivot
2	03-0070-7		Riser Weldment, Pivot
3	03-0810-6		Tie, Pivot, 2nd From Bottom
4	03-0830-4		Tie, Pivot, Top
5	03-1110-0		Brace, Truss Side, 51-1/2"
6	03-4600-7		Leg, Heavy Duty, Pivot, 11'
7	03-4772-4		Anchor Weld., Pivot, Non-Tow
8	03-6939-7		Tie, Pivot Bottom, 92"
9	04-0063-0		Strap, Pivot Riser
10	04-4775-5		Washer, Rect., 15/16" x 2-1/2 x 3"
11	06-0804-2		Screw, 1/2-13 x 1-1/4", Hex, Gr.5
12	06-0809-1		Screw, 3/4-10 x 2", Hex, Gr.5
13	06-0839-8		Screw, 5/8-11 x 1-1/2", Hex, Gr. 5
14	06-2416-3		Nut, 5/8-11, Lock

Ref.	Original Part No.	Substitute Part No.	Description
15	06-2417-1		Nut, 3/4-10, Lock
16	06-2418-9		Nut, 1/2-13, Lock
17	11-0024-7		Nut, 7/8-9, Lock, Nylon Insert
18	11-0046-0		Decal, "Grease"
19	11-0470-2		Zerk, 5/16", Drive-In
20	11-9461-0		Tie, Pivot, Panel Mount, Top
21	11-9462-0		Tie, Pivot, Panel Mount, Bottom
22	26-0760-4		Screw, 1/2-13 x 1-1/2", Hex, Gr. 5
23	03-4776-5		Bolt, Pivot Anchor, Non-Tow (Opt)
24	03-4797-1		Bundle, Pivot, Galvanized (includes Items 3, 4, 8, 9, 20 & 21)
25	03-4799-7		Bundle, Pivot Tie, 3 Sides (includes 3 of Items 4, 5, & 8)
26	10-3576-5		Bolt, Pivot Anchor, 1-1/4"